

488 VERNON WAY

EL CAJON, CA 92020

FOR SUBLEASE

±3,000 SF
OFFICE/
WAREHOUSE

BRET MORRISS

619-870-8665

bret.morriss@cast-cap.com

Licence #02037074

BUSTER HOY

619-952-7107

buster.hoy@cast-cap.com

License #02123670

CAST
CAPITAL PARTNERS

FLOOR PLAN

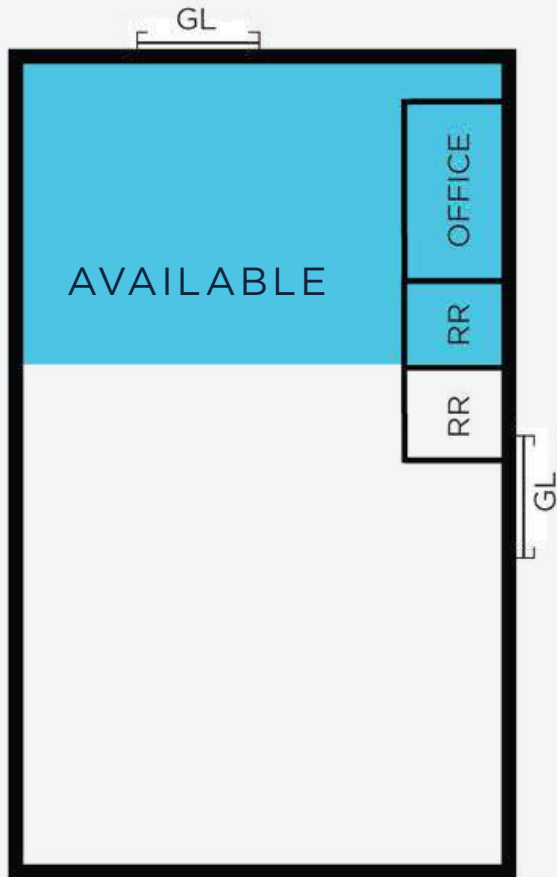

PROPERTY HIGHLIGHTS



**488 Vernon Way, El
Cajon CA 92020**



**±3,000 SF
(5% Office 95% Warehouse)**



Sublease Rate: \$1.75 PSF + Elec.
(LESSOR PAYS PROPERTY TAXES,
INSURANCE, AND MAINTENANCE)



(1) 12'x14'
GRADE LEVEL DOORS



14.5 - 24'
CLEAR HEIGHT



2 SPACES
PARKING



PARTIAL
SPRINKLER



M ZONE EL CAJON
ZONING



I-8 and Highways 67, 52 & 125
PROXIMITY





- 7-Eleven
- AT&T
- AutoZone
- Chase Bank
- Chevron
- Chick-fil-A
- Chipotle
- Costco
- Epic Wings
- Jersey Mike's
- Lowe's
- O'Reilly
- Phil's BBQ
- Sprouts
- Starbucks
- Subway
- T-Mobile
- Taco Bell
- Target
- Union Bank
- UPS Store
- USPS
- Verizon
- Vons

PROPERTY

- Bank of America
- Best Buy
- Burger King
- CVS
- Dunkin'
- Five Guys
- Home Depot
- In-N-Out
- Jamba Juice
- KFC
- McDonald's
- Mission Federal
- Navy Federal
- Panera Bread
- Smart & Final
- Texas Roadhouse
- Urbane Cafe
- Walmart
- Wells Fargo

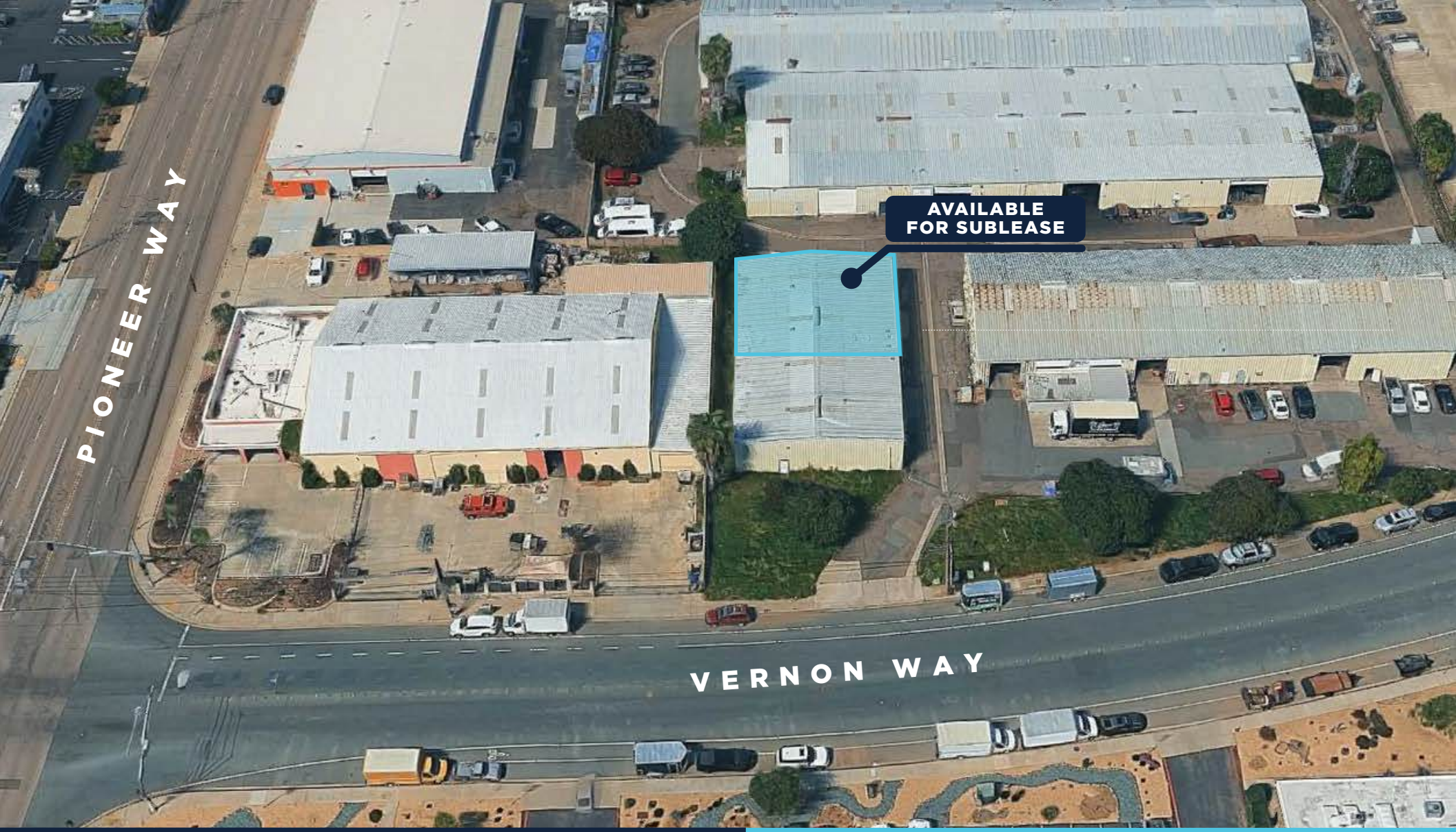

**AVAILABLE
FOR SUBLEASE**

CAST
CAPITAL PARTNERS

5090 Shoreham Place Suite 100
San Diego, CA 92122
information@cast-cap.com
619-308-6680

www.Cast-Cap.com

BRET MORRISS
619-870-8665
bret.morriss@cast-cap.com
Licence #02037074

BUSTER HOY
619-952-7107
buster.hoy@cast-cap.com
License #02123670

This information above was obtained from sources deemed reliable. No warranties or representations, expressed or implied, are made as to the accuracy of the information contained herein, and same is submitted subject errors, omissions, change of price, rental or other conditions, withdrawal without notice, and to any special listing conditions imposed by our principals. This information is given with the understanding that all negotiations relating to the purchase, renting or leasing of the property described herein shall be conducted through CAST Capital Partners.